



**THE PEACEFUL  
HOMES**

---

PREMIUM RESIDENCES AT GURGAON

welcome to the  
**PEACEFUL**  
homes



## THE PEACEFUL JOURNEY

In AIPL's definition, The Peaceful Homes is not just about the serene and peaceful location of the said project but also a peaceful experience throughout the journey starting from the booking of your apartment through completion and handover.

Even after handover, AIPL endeavours to provide complete support to eliminate the hassles of moving into a new community for a better quality of life and living experience thereby ensuring a complete stress free and peaceful lifestyle in sync with the philosophy and core values of the company.



Let  
PEACE  
surround you



ARTISTIC IMPRESSION

Disclaimer: All layout plans, site plans, typical unit plans, renderings, areas, dimensions and specifications are subject to change till final completion of the Project. Soft furnishing, furniture and gadgets are not part of the offering.

## THE PEACEFUL RESIDENCES

At The Peaceful Homes, the only thing that you will not find is the reason to worry. These residential towers have been brought together by employing the most progressive technologies in construction.

- Choices of 2/3/4 Bedroom Premium Residences
- Spread over sprawling greens • Multi-Storey Premium Homes
- Panoramic views of the Aravalli range • Convenient Shopping Centre
- Exclusive club with modern facilities • 24x7 DG Power back-up
- Well connected to NH-8 & Sohna Road with proximity to SPR (Southern Periphery Road)
- In the vicinity of proposed metro route • 24x7 water supply
  - Efficient passenger elevators
  - Fire protection & detection system as per NBC norms
  - 24 hrs. security with access control & CCTV surveillance

# SITE PLAN

## LEGEND

- A Adult Pool
- B Kid's Pool
- C Lounge Pool
- D Pool Deck
- E Tennis Court
- F Badminton Court
- G Basketball Practice Court
- H Football Practice Ground
- I Drop Off Plaza
- J Kid's Play Area
- K Children's Play Area
- L Skating Zone
- M Water Feature
- N Water Body
- O Mound
- P Ramp
- Q Lawn
- R Hopscotch
- S Parking Area
- T Jogging Track

## THE PEACEFUL LOCATION

Set against the majestic backdrop of the Aravallis, The Peaceful Homes are nothing short of a work of art. Well connected to NH 8 and Golf Course Road and in close proximity to Southern Periphery Road (SPR), these residences give you immediate access to the best Gurgaon has to offer. From the best options in retail and commercial developments to schools, a bustling office hub, hospitals, colleges and world class recreational facilities.

- International schools like Indus World, GD Goenka, Heritage and Amity just few minutes away
  - Medanta, Fortis, Artemis and Max hospital in proximity
  - The best MNCs, Colleges and Universities of Gurgaon just a short drive away
- Close to three golf courses i.e. Classic Golf Resort, Golden Greens and DLF Golf & Country Club



TOWERS AMENITY IN

TOWER B

TOWER C

TOWER A

CLUB RESIDENCES

CLUBHOUSE

60M WIDE ROAD  
12M WIDE SERVICE ROAD

24M WIDE ROAD

DRIVEWAY 7.5M WIDE

DRIVEWAY 7.5M WIDE

DRIVEWAY 3.5M WIDE

DRIVEWAY 7.5M WIDE



Not to scale

## THE PEACEFUL LOCATION

Set against the majestic backdrop of the Aravallis, The Peaceful Homes are nothing short of a work of art. Well connected to NH 8 and Golf Course Road and in close proximity to Southern Periphery Road (SPR), these residences give you immediate access to the best Gurgaon has to offer. From the best options in retail and commercial developments to schools, a bustling office hub, hospitals, colleges and world class recreational facilities.

- International schools like Indus World, GD Goenka, Heritage and Amity just few minutes away
  - Medanta, Fortis, Artemis and Max hospital in proximity
  - The best MNCs, Colleges and Universities of Gurgaon just a short drive away
- Close to three golf courses i.e. Classic Golf Resort, Golden Greens and DLF Golf & Country Club





## THE PEACEFUL EXPERIENCE

There is no peace without pleasure. At The Peaceful Homes we have ensured every little detail to fill your days with magical moments and your evenings with unforgettable memories. The best international techniques have been employed to create a seamlessness seldom found in residential complexes. It is truly a tribute to fine living sculpted out of sheer passion and the desire to make sure you never have anything to worry about.



## Facilities

- Jogging track • Pet garden • Meditation garden • Badminton/Basketball/Football practice courts
- Convenient location of amenities like nursery, primary schools, recreational club, retail areas
- Provision of Grocery store, Florist, ATM, Laundromat, Mobile shop, Courier collection shop, Facility shop, Dry cleaning/Ironing, First aid room/Pathology lab/Chemist, Bakery, Fruits & Vegetables, Saloon, Stationery, Tailor, Shoe shop/cobbler, Small departmental store
- Facility for charging electric vehicles- both two-wheelers & four-wheelers • Driver waiting area
- Separate service elevators for domestic help • Dual energy prepaid billing system • Auto car wash
- Access for Disabled • Services Convenience for support staff • Provision for intercom facility
- Ground Floor & basements : Air-conditioned entrance lobby • Eco friendly design concepts
- Garbage disposal system-Chutes • Storm water drainage & recharge system
- 100% groundwater recharge through rain water harvesting structure
- Re-use of treated water from central STP for flushing and horticulture
- Solid waste management through efficient collection and transportation systems



## BE BLESSED WITH BLISS

Walk through the doors of an Air-conditioned apartment at The Peaceful Homes to enter a world of sublime serenity. Discover the symphony of ethereal design and superior architecture as you walk upon elegantly appointed Imported marble/Engineered stone and laminated flooring. Admire in wonderment the abundance of light pouring through the large windows to fill your spacious abode with joy and love. And then kick back and savour a rare life replete with all modern amenities and gadgets of an ultra modern home.



**Air**  
**Conditioned**  
**APARTMENTS**



Disclaimer: Utility area, Kitchen, Powder Room & Toilets shall not be provided with air conditioning.

## WHERE FAMILIES COME TOGETHER

We believe that the kitchen is the heart of every home. A guiding principle reflected beautifully at The Peaceful Homes. Bring the family together as you dish out oodles of love in the form of special delicacies. Experience the best fits and finish to complement to suit your taste.

- Modular kitchen with hob & chimney
- Modern fittings & fixtures
- Granite counter top
- Double bowl stainless steel sinks
- Anti skid ceramic tiles
- Acrylic emulsion



# THE PEACEFUL DESIGN

## 4 Bedroom+Utility Room

Super Area - 2925 sq. ft.



### LEGEND

| Unit                  | Size            |
|-----------------------|-----------------|
| A. Living/Dining Room | 25'-3" x 14'-9" |
| B. Private Terrace    | 5'-10.8" wide   |
| C. Passage Area       | 3'-11" wide     |
| D. Utility Area       | 6'-6" x 8'-11"  |
| E. Utility Toilet     | 5'-10" x 4'-8"  |
| F. Kitchen            | 12'-1" x 8'-2"  |
| G. Utility Balcony    | 5'-5" wide      |
| H. Powder Room        | 4'-9" x 6'-1"   |
| I. M. Bedroom         | 12'-4" x 14'-2" |
| J. M. Toilet          | 10'-0" x 9'-9"  |
| K. Dress Area         | 5'-4" x 6'-4"   |
| L. M. Bedroom Balcony | 5'-2" wide      |
| M. Bedroom 02         | 11'-2" x 13'-3" |
| N. Toilet 02          | 5'-8" x 8'-6"   |
| O. Balcony            | 5'-10.8" wide   |
| P. Bedroom 03         | 11'-1" x 13'-3" |
| Q. Toilet 03          | 5'-10" x 8'-2"  |
| R. Bedroom 04         | 13'-2" x 11'-1" |
| S. Toilet 04          | 5'-8" x 8'-1"   |

1 sq. ft. = 0.0929 sq. mtr.

Not To Scale

**Disclaimer:** All layout plans, site plans, typical unit plans, renderings, areas, dimensions and specifications are subject to change till final completion of the Project. Soft furnishing, furniture and gadgets are not part of the offering.

# THE PEACEFUL DESIGN

## 3 Bedroom + Utility Room : Type 3

Super Area - 2475 sq. ft.

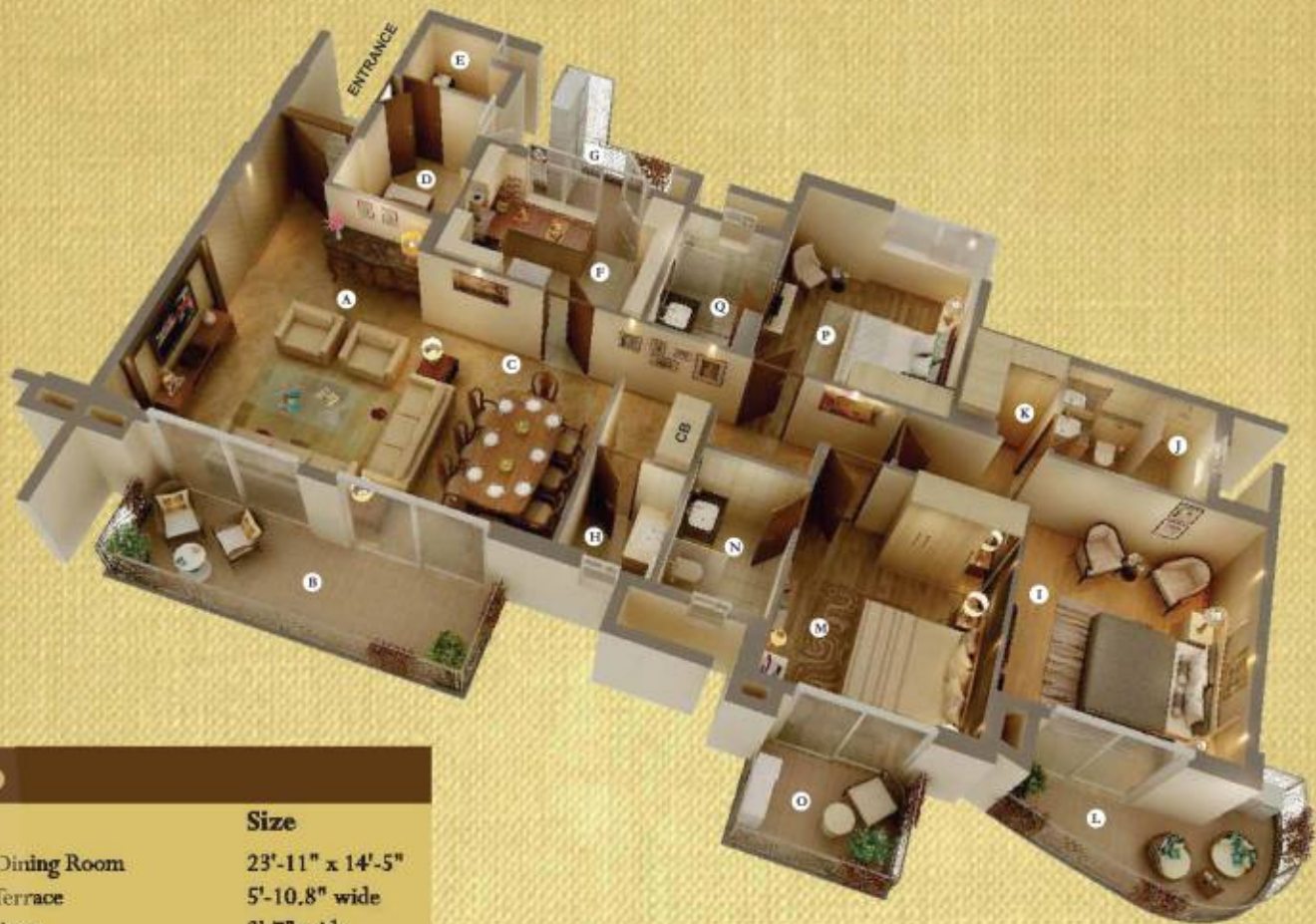

### LEGEND

| Unit                  | Size             |
|-----------------------|------------------|
| A. Living/Dining Room | 23'-11" x 14'-5" |
| B. Private Terrace    | 5'-10.8" wide    |
| C. Passage Area       | 3'-7" wide       |
| D. Utility Room       | 6'-6" x 8'-11"   |
| E. Utility Toilet     | 5'-10" x 4'-7"   |
| F. Kitchen            | 11'-9" x 8'-2"   |
| G. Utility Balcony    | 5'-5" wide       |
| H. Powder Room        | 4'-9" x 6'-1"    |
| I. M. Bedroom         | 12'-4" x 14'-1"  |
| J. M. Toilet          | 8'-10" x 6'-     |
| K. Dress Area         | 4'-11" x 6'-1"   |
| L. M. Bedroom Balcony | 5'-2" wide       |
| M. Bedroom 02         | 11'-0" x 13'-3"  |
| N. Toilet 02          | 5'-8" x 8'-6"    |
| O. Balcony            | 5'-10.8" wide    |
| P. Bedroom 03         | 11'-2" x 13'-2"  |
| Q. Toilet 03          | 5'-8" x 8'-2"    |

1 sq. ft. = 0.0929 sq. mtr.

Not To Scale

**Disclaimer:** All layout plans, site plans, typical unit plans, renderings, areas, dimensions and specifications are subject to change till final completion of the Project. Soft furnishing, furniture and gadgets are not part of the offering.

## 3 Bedroom+Utility Room :Type 2

Super Area - 2350 sq. ft.



### LEGEND

| Unit                  | Size            |
|-----------------------|-----------------|
| A. Living/Dining Room | 23'-9" x 14'-1" |
| B. Private Terrace    | 5'-10.8" wide   |
| C. Passage Area       | 3'-7" wide      |
| D. Utility Area       | 6'-2" x 8'-11"  |
| E. Utility Toilet     | 5'-10" x 4'-10" |
| F. Kitchen            | 11'-11" x 8'-2" |
| G. Utility Balcony    | 4'-11" wide     |
| H. M. Bedroom         | 12'-4" x 14'-1" |
| I. M. Toilet          | 8'-10" x 6'-1"  |
| J. Dress Area         | 5'-5" x 5'-10"  |
| K. M. Bedroom Balcony | 5'-2" wide      |
| L. Bedroom 02         | 11'-0" x 13'-3" |
| M. Toilet 02          | 5'-5" x 8'-2"   |
| N. Balcony            | 5'-10.8" wide   |
| O. Bedroom 03         | 11'-2" x 13'-3" |
| P. Toilet 03          | 5'-7" x 8'-2"   |

1 sq. ft. = 0.0929 sq. mtr.

Not To Scale

**Disclaimer:** All layout plans, site plans, typical unit plans, renderings, areas, dimensions and specifications are subject to change till final completion of the Project. Soft furnishing, furniture and gadgets are not part of the offering.

## 3 Bedroom : Type 1

Super Area - 2150 sq. ft.



### LEGEND

| Unit                  | Size             |
|-----------------------|------------------|
| A. Living/Dining Room | 22'-11" x 13'-7" |
| B. Private Terrace    | 5'-10.8" wide    |
| C. Passage Area       | 3'-7" wide       |
| D. Utility Area       | 6'-1" x 5'-5"    |
| E. Utility Balcony    | 5'-5" wide       |
| F. Kitchen            | 8'-5" x 10'-7"   |
| G. M. Bedroom         | 12'-1" x 13'-9"  |
| H. M. Toilet          | 8'-4" x 5'-8"    |
| I. Dress Area         | 5'-1" x 6'-4"    |
| J. M. Bedroom Balcony | 5'-2" wide       |
| K. Bedroom 02         | 11'-1" x 13'-3"  |
| L. Toilet 02          | 8'-7" x 5'-5"    |
| M. Bedroom 03         | 13'-2" x 11'-1"  |
| N. Toilet 03          | 5'-3" x 8'-2"    |
| O. Balcony            | 5'-10.8" wide    |

1 sq. ft. = 0.0929 sq. mtr.

Not To Scale

**Disclaimer** : All layout plans, site plans, typical unit plans, renderings, areas, dimensions and specifications are subject to change till final completion of the Project. Soft furnishing, furniture and gadgets are not part of the offering.

## 2 Bedroom : Type 1

Super Area - 1565 sq. ft.



### LEGEND

| Unit                  | Size             |
|-----------------------|------------------|
| A. Living/Dining Room | 21'-7" x 13'-4"  |
| B. Private Terrace    | 5'-2" wide       |
| C. Passage Area       | 3'-6" wide       |
| D. Utility Area       | 4'-9" x 5'-5"    |
| E. Kitchen            | 8'-3" x 10'-6"   |
| F. Utility Balcony    | 5'-1" wide       |
| G. M. Bedroom         | 11'-10" x 14'-1" |
| H. M. Toilet          | 8'-2" x 5'-3"    |
| I. M. Bedroom Balcony | 4'-8" wide       |
| J. Bedroom 02         | 11'-0" x 13'-3"  |
| K. Toilet 02          | 8'-8" x 5'-2"    |
| L. Balcony            | 4'-3.1" wide     |

1 sq. ft. = 0.0929 sq. mtr.

Not To Scale

**Disclaimer** : All layout plans, site plans, typical unit plans, renderings, areas, dimensions and specifications are subject to change till final completion of the Project. Soft furnishing, furniture and gadgets are not part of the offering.

## 2 Bedroom + Utility : Type 2

Super Area - 1719 sq. ft.



### LEGEND

| Unit                  | Size            |
|-----------------------|-----------------|
| A. Living/Dining Room | 21'-7" x 13'-4" |
| B. Private Terrace    | 5'-11" wide     |
| C. Passage Area       | 3'-6" wide      |
| D. Utility Area       | 6'-9" x 9'-11"  |
| E. Utility Toilet     | 4'-5" x 6'-2"   |
| F. Kitchen            | 8'-3" x 12'-7"  |
| G. Utility Balcony    | 4'-11" wide     |
| H. M. Bedroom         | 14'-1" x 12'    |
| I. M. Toilet          | 5'-5" x 9'-5"   |
| J. M. Bedroom Balcony | 5'-11" wide     |
| K. Bedroom 02         | 13'-2" x 11'    |
| L. Toilet 02          | 5'-5" x 8'-8"   |

1 sq. ft. = 0.0929 sq. mtr.

Not To Scale

**Disclaimer** : All layout plans, site plans, typical unit plans, renderings, areas, dimensions and specifications are subject to change till final completion of the Project. Soft furnishing, furniture and gadgets are not part of the offering.

| Location              | Living Room                        | Master Bed Room                      | Other Bed Rooms                      | Kitchen   |
|-----------------------|------------------------------------|--------------------------------------|--------------------------------------|---|
| <b>Walls</b>          | Acrylic emulsion                   | Acrylic emulsion                     | Acrylic emulsion                     | Ceramic Tiles upto 2 feet above the counter and rest Acrylic emulsion                                   |
| <b>Floor</b>          | Imported marble / Engineered Stone | Laminated Wooden flooring            | Laminated Wooden flooring            | Anti-Skid Ceramic Tiles   |
| <b>Ceiling</b>        | OBD                                | OBD                                  | OBD                                  | OBD   |
| <b>Doors</b>          | Main Door: Veneered with polish    | Internal door: Skin moulded shutters | Internal door: Skin moulded shutters | Internal door: Skin moulded shutters  |
|                       | External door: UPVC / Aluminium    | External door: UPVC / Aluminium      | External door: UPVC / Aluminium      | External door: UPVC / Aluminium   |
| <b>Window Glazing</b> | UPVC / Aluminium                   | UPVC / Aluminium                     | UPVC / Aluminium                     | UPVC / Aluminium  |
| <b>Others</b>         | Split AC                           | Split AC                             | Split AC                             | Modular Kitchen with Hob & Chimney, Granite counter top, double bowl stainless steel sink & CP fittings |

**Disclaimer:** All layout plans, site plans, typical unit plans, renderings, areas, dimensions and specifications are subject to change till final completion of the Project. Soft furnishing, furniture and gadgets are not part of the offering. Marble / Granite being natural material have inherent characteristics of color and grain variations. Utility area, kitchen & toilets shall not be provided with air conditioning. The extent / number / variety of the equipments / appliances and their make / brand thereof are tentative and liable to change at sole discretion of the Company.

\* As Applicable

# SPECIFICATIONS

| Balconies & Terraces    | Toilets   | Powder Room*  | Utility Room                    | Utility Toilets                           |
|-------------------------|---|---|---------------------------------|---|
| Weather proof paint     | Ceramic Tiles upto Door height, rest Acrylic emulsion                   | Ceramic Tiles upto Door height rest Acrylic emulsion                    | OBD                             | Ceramic Tiles upto Door Height, rest OBD  |
| Anti-Skid Ceramic Tiles | Anti-Skid Ceramic Tiles   | Anti-Skid Ceramic Tiles   | Anti-Skid Ceramic Tiles         | Anti-Skid Ceramic Tiles                   |
| Weather proof paint     | OBD   | OBD   | OBD                             | OBD                                       |
| UPVC / Aluminium        | Internal door: Skin moulded shutters                                    | Internal door: Skin moulded shutters                                    | Flush Door with Enamel Paint    | Flush Door with Enamel Paint              |
|                         |   |   | External door: UPVC / Aluminium |   |
| UPVC / Aluminium        | UPVC / Aluminium  | UPVC / Aluminium  | UPVC / Aluminium                | UPVC / Aluminium                          |
| MS Designer Railings    | Quality Chinaware, CP fittings, Natural Stone/ Engineered Stone counter | Quality Chinaware, CP fittings, Natural Stone/ Engineered Stone counter | -                               | Conventional CP fittings, White Chinaware |

**Disclaimer:** All layout plans, site plans, typical unit plans, renderings, areas, dimensions and specifications are subject to change till final completion of the Project. Soft furnishing, furniture and gadgets are not part of the offering. Marble / Granite being natural material have inherent characteristics of color and grain variations. Utility area, kitchen & toilets shall not be provided with air conditioning. The extent / number / variety of the equipments / appliances and their make / brand thereof are tentative and liable to change at sole discretion of the Company.

# SPECIFICATIONS

## THE PEACEFUL CLUB

Bliss is the centrepiece of life at The Peaceful Homes. And what better way to find it in the midst of your family and friends.

Welcome to Tantra- an ultramodern club brimming with one thoughtful facility after another.

- Multi purpose hall • Library / Reading room
  - Yoga center • Gymnasium
  - Spa facilities, sauna and steam
  - Business Centre • Concierge Desk
- Mini home theatre • Open air LED screen
- Guest Rooms • Billiards room and Table Tennis Facility
- Lounge Area • Swimming pool • Barbeque Area
  - Wifi in landscaped areas
  - Piped music in Landscaped areas



# TANTRA THE CLUB

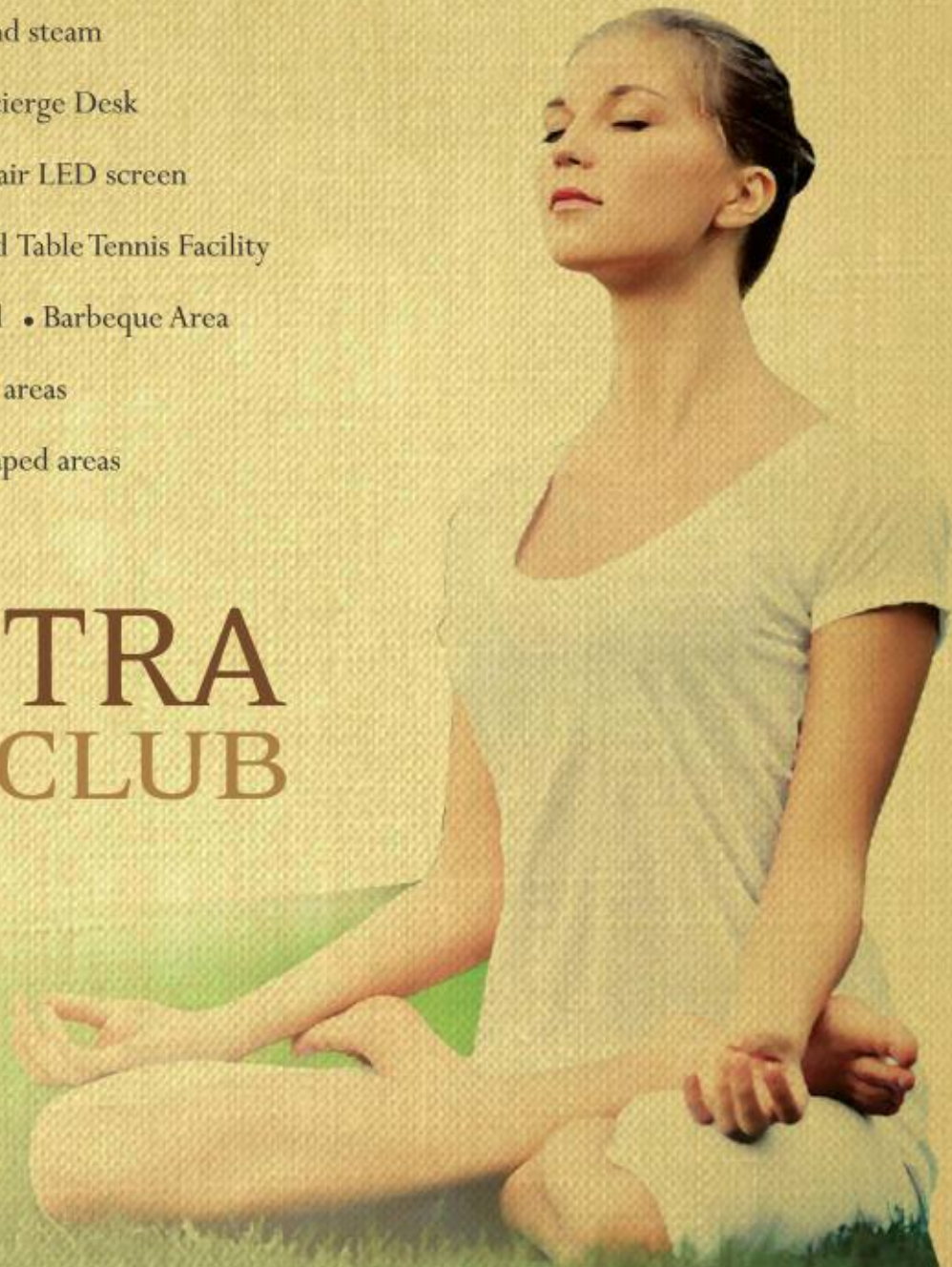



*Marketed by:*



**Madhyam.com**

Follow us on:   /TeamMadhyam

E-mail: [info@madhyam.com](mailto:info@madhyam.com)

---

DELHI | NOIDA | GURUGRAM | FARIDABAD | BHIWADI | CHANDIGARH